

FORM NO 1.

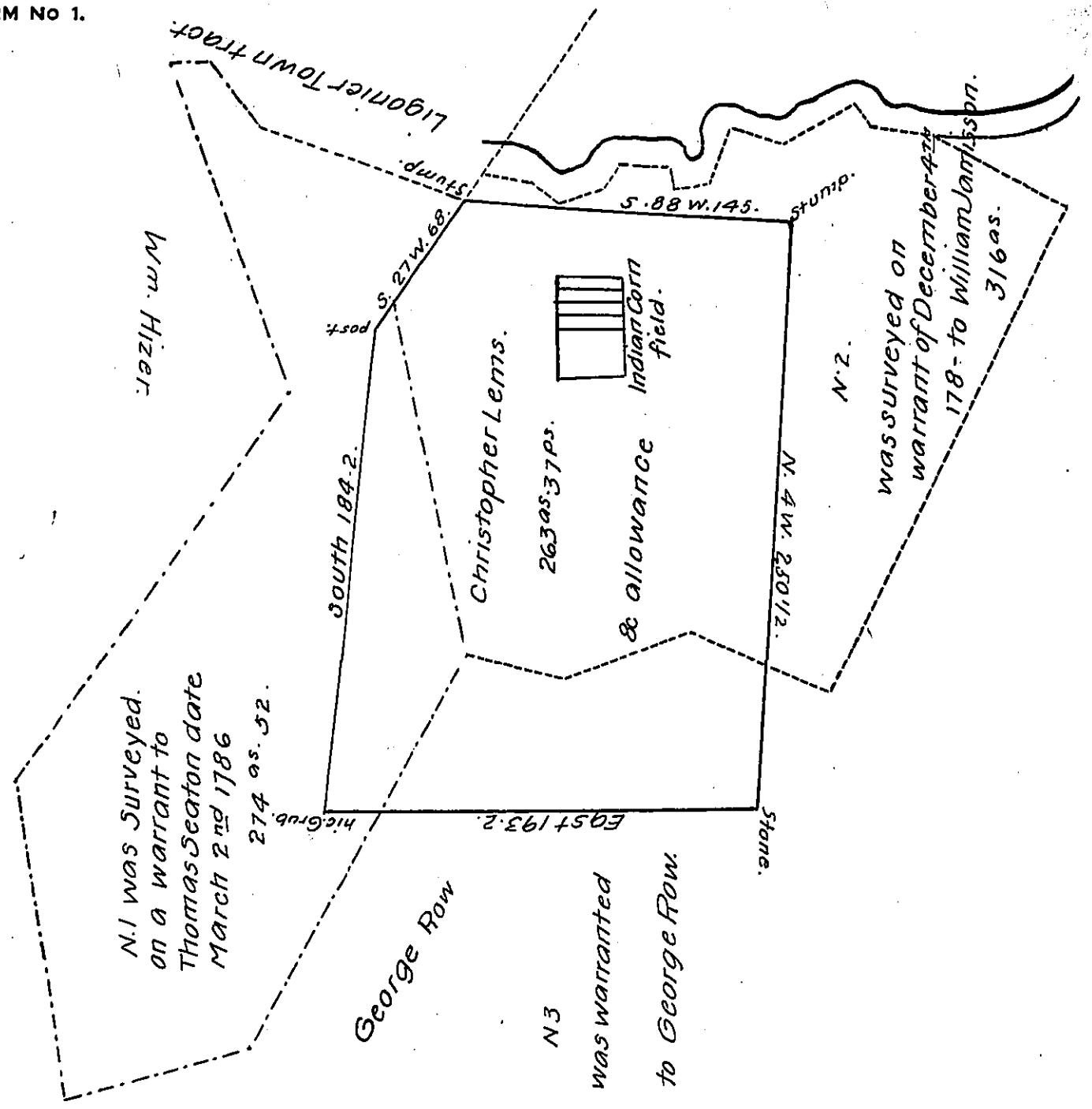

In pursuance of an Application granted to Christopher Lems N^o 2111 dated 3^d of April 1769 Surveyed on the 9th of December 1828 the above described tract of land containing two hundred and sixty three acres ~~and~~ thirty seven ~~and~~ perches and the allowance proportioned at Six per Cent. for Roads & Situate near the Loyalhanna creek in Ligonier Township Westmoreland County Pa.

Gabriel Hiester Esq^r, } S. L. Carpenter, D.S.
 Surveyor General of Pa. }
 (Explanation on another sheet.)

IN TESTIMONY that the above is a copy of the original remaining on file in the Department of Internal Affairs of Pennsylvania, made conformably to an Act of Assembly approved the 16th day of February, 1833, I have hereunto set my Hand and caused the Seal of said Department to be affixed at Harrisburg, this tenth day of February, 1909.

Hurry Howell
 Secretary of Internal Affairs.